

PEDAL ASSEMBLY IS COMPATIBLE WITH TILTON ENGINEERING 73, 74, 75 OR 76 SERIES MASTER CYLINDERS SOLD SEPERATELY
 75 SERIES MASTER CYLINDERS SHOWN HERE ARE FOR ILLUSTRATION PURPOSES ONLY AND ARE NOT INCLUDED WITH PEDAL ASSEMBLY

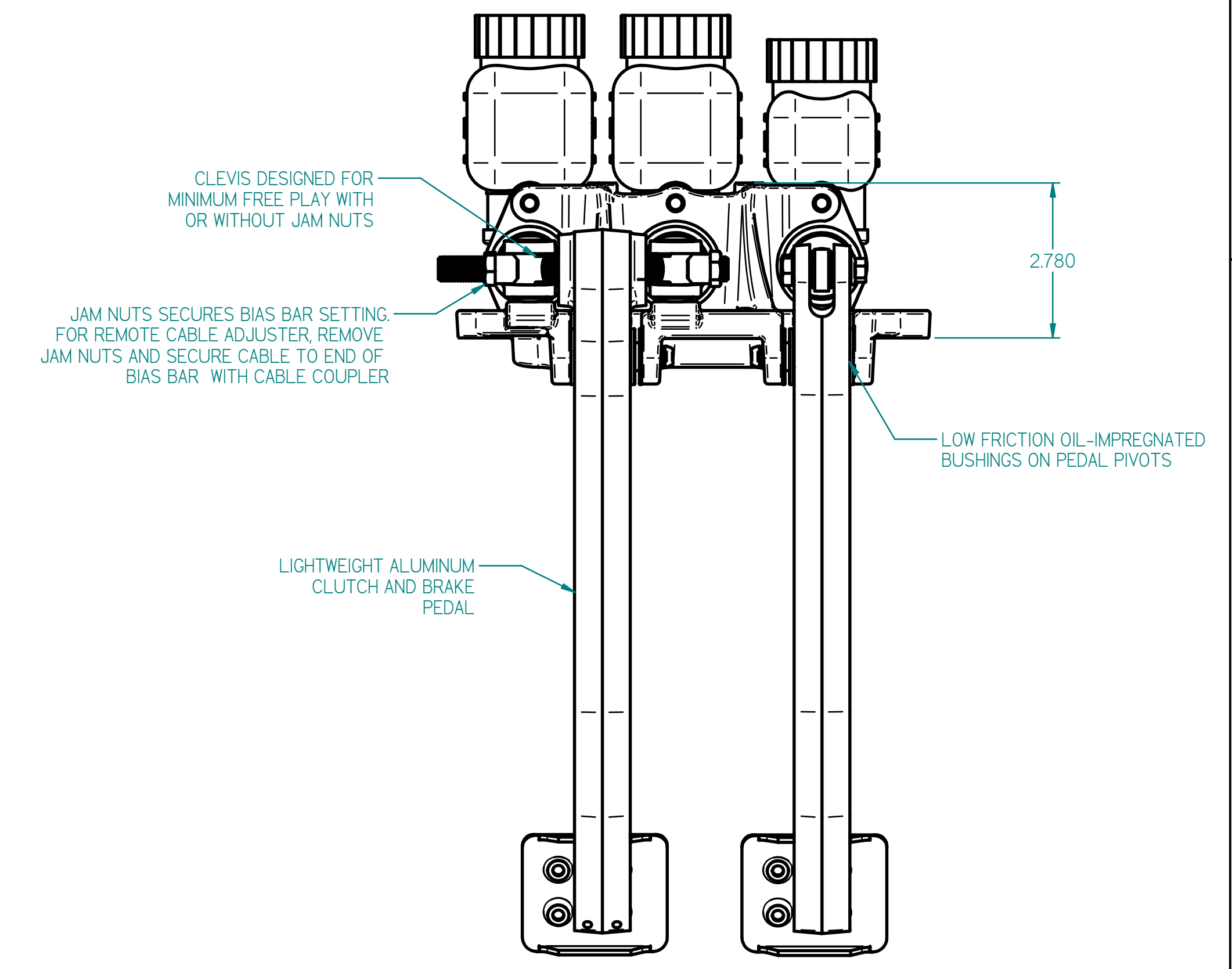
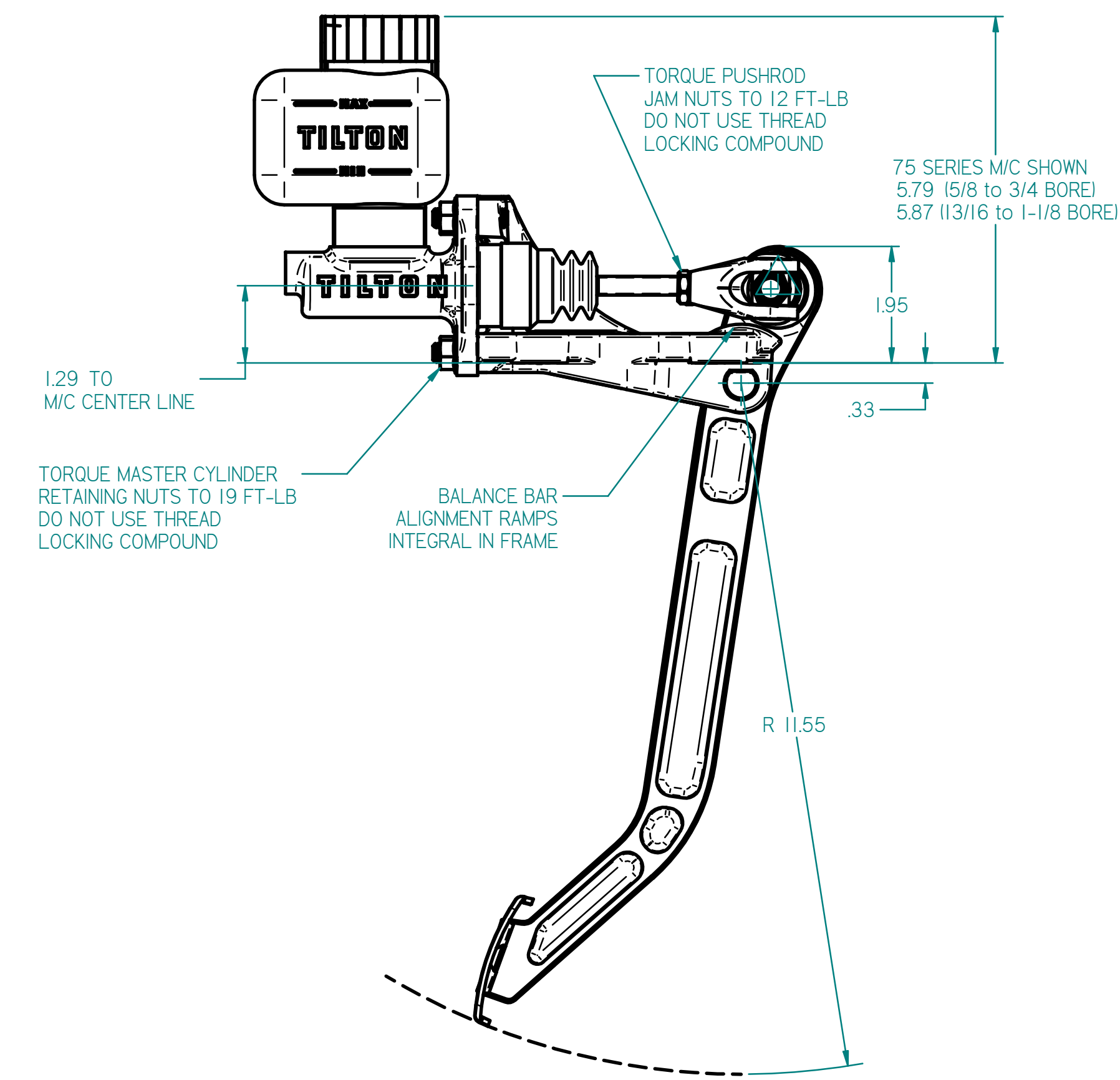
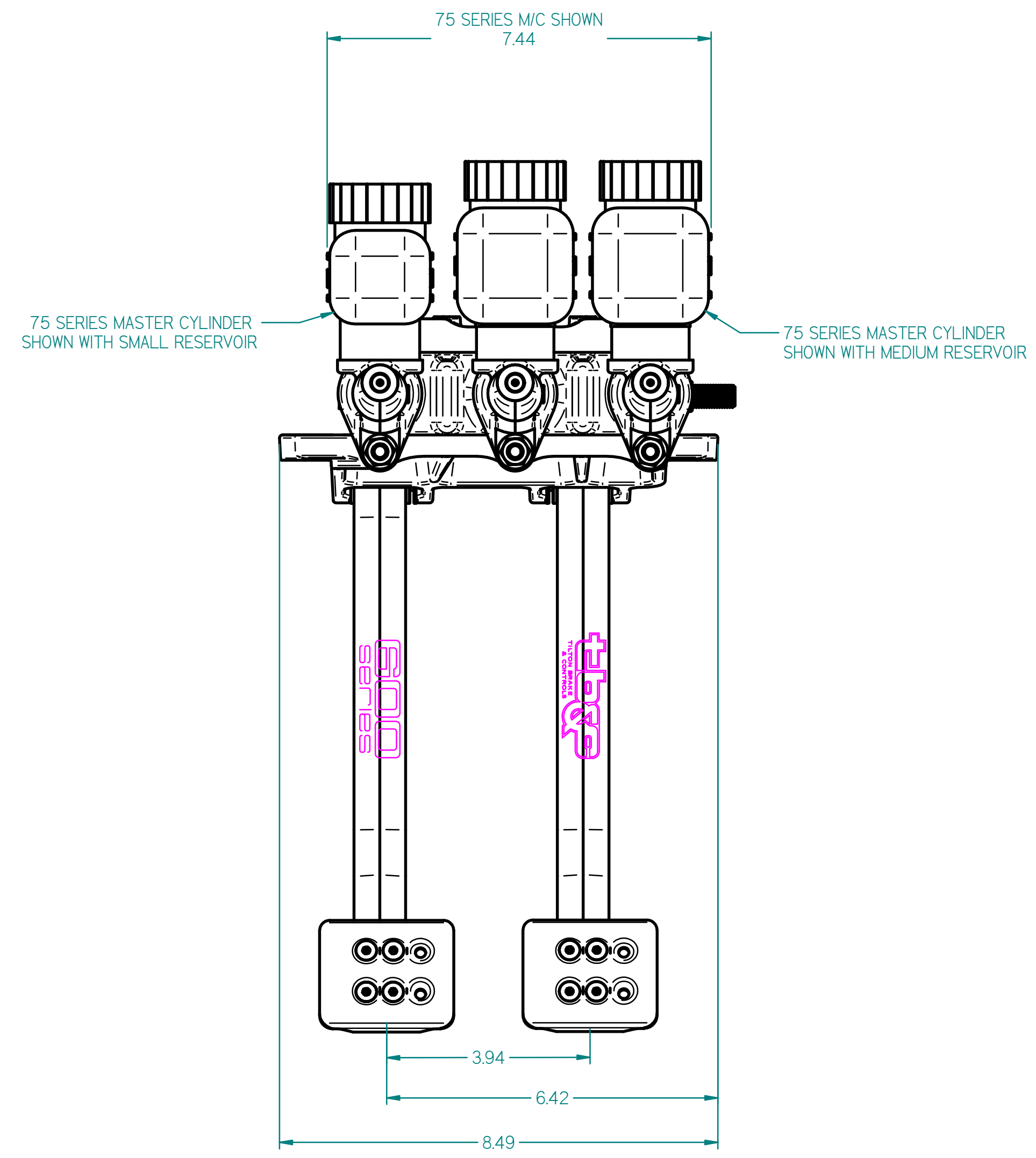
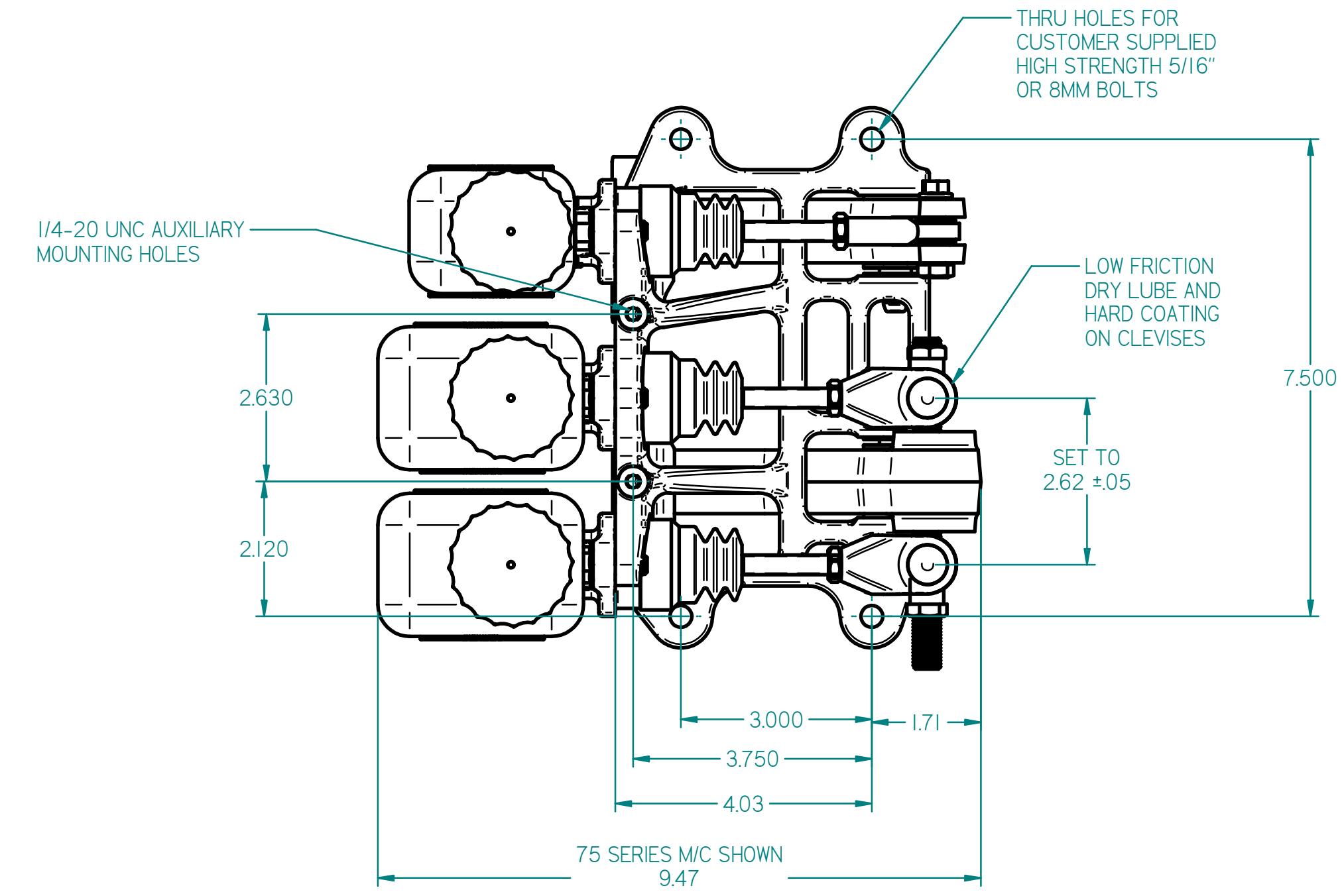

NOTES:
 1. UNLESS OTHERWISE SPECIFIED, ALL DIMENSIONS ARE INCHES
 2. DIMENSIONS ARE NOMINAL
 3. WEIGHT :

TOLERANCES: UNLESS SPECIFIED OTHERWISE		MATERIAL		TILTON ENGINEERING, INC. (805)688-2353 FAX (805)688-2745	
.X ± .020	DRILL HOLES	COND		25 EASY STREET P.O. BOX 1787 BUELLTON, CALIFORNIA 93427 USA	
.XX ± .010	.013-.040: +.001/- .001	HARD		TITLE: INSTALLATION DRAWING	
.XXX ± .005	.041-.130: +.002/- .001	FINISH	DRN BY VAN SCHMUS	CHK'D	SCALE 1:2
FRACT ± 1/32	.131-.229: +.003/- .001	SPEC	P/N 72-602	DATE 03/02/06	DWG SHEET 1 OF 1
ANGLE ± 1/2°	.230-.500: +.004/- .001				5041
CONC(TIR) .005	.501-.750: +.005/- .001				
	.751-1.000: +.007/- .001				
	1.001-2.000: +.010/- .001				

"This document contains proprietary information of TILTON ENGINEERING, INC., and its receipt or possession does not convey the rights to reproduce, disclose its contents, or to manufacture, use or sell anything it may describe. Reproduction, disclosure, or use without specific written authorization of TILTON ENGINEERING, INC. is strictly forbidden."

TILTON ENGINEERING